

# \$649,888 - 5811 Kootook Link, Edmonton

MLS® #E4426618

**\$649,888**

3 Bedroom, 2.50 Bathroom, 2,167 sqft  
Single Family on 0.00 Acres

Keswick Area, Edmonton, AB

Single family home designed for modern living in Arbours of Keswick! Featuring double attached garage and \$5K appliance allowance. Step inside to find a thoughtfully designed main floor, starting with a versatile den at the entrance. The open-concept living area with open to above ceilings, seamlessly connecting the dining space and dream kitchen. The kitchen is a chefâ€™s delight, featuring 3m quartz countertops, stylish light wood-toned cabinetry, and a walk-in pantry. A dedicated office off the kitchen provides a space for work or study. Upstairs, a bonus room offers additional living space, accompanied by a full bathroom, laundry room, and three generously sized bedrooms. The luxurious primary suite is a true retreat, featuring two walk-in closets and a spa-inspired ensuite with double sinks, a walk-in shower, and a relaxing soaker tub. Donâ€™t miss this incredible opportunityâ€”your dream home awaits!

November - December 2025 tentative completion. Photos are renderings of interior colors only. HOA TBD

Built in 2025

## Essential Information

MLS® # E4426618  
Price \$649,888

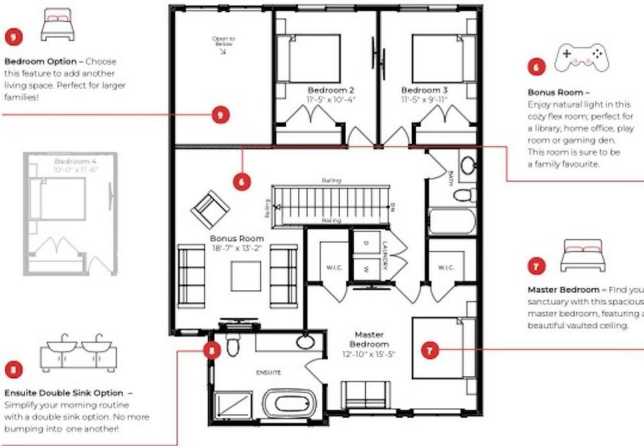
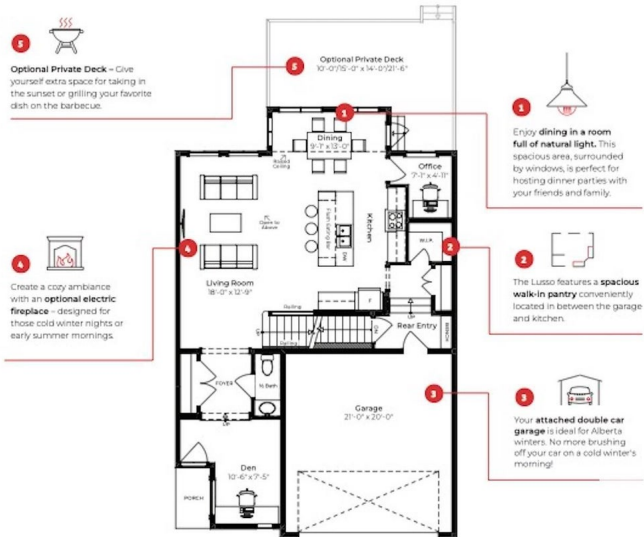

|                |                        |
|----------------|------------------------|
| Bedrooms       | 3                      |
| Bathrooms      | 2.50                   |
| Full Baths     | 2                      |
| Half Baths     | 1                      |
| Square Footage | 2,167                  |
| Acres          | 0.00                   |
| Year Built     | 2025                   |
| Type           | Single Family          |
| Sub-Type       | Detached Single Family |
| Style          | 2 Storey               |
| Status         | Active                 |

### Community Information

|             |                   |
|-------------|-------------------|
| Address     | 5811 Kootook Link |
| Area        | Edmonton          |
| Subdivision | Keswick Area      |
| City        | Edmonton          |
| County      | ALBERTA           |
| Province    | AB                |
| Postal Code | T6W 4Z6           |

### Amenities

|           |                            |
|-----------|----------------------------|
| Amenities | Ceiling 9 ft., See Remarks |
| Parking   | Double Garage Attached     |

### Interior

|                   |  |
|-------------------|--|
| Interior Features | ensuite bathroom                                     |
| Appliances        | Garage Control, Garage Opener, Hood Fan, See Remarks |
| Heating           | Forced Air-1, Natural Gas                            |
| Stories           | 2  |
| Has Basement      | Yes  |
| Basement          | Full, Unfinished                                     |

### Exterior

|                   |   |
|-------------------|---|
| Exterior          | Wood, Vinyl, Hardie Board Siding  |
| Exterior Features | Airport Nearby, Playground Nearby, Schools, Shopping Nearby, Stream/Pond, See Remarks |
| Roof              | Asphalt Shingles  |
| Construction      | Wood, Vinyl, Hardie Board Siding  |

Foundation                      Concrete Perimeter

**Additional Information**

Date Listed                      March 20th, 2025  
Days on Market                30  
Zoning                              Zone 56  
HOA Fees                         1  
HOA Fees Freq.                Annually

DATA IS DEEMED RELIABLE BUT IS NOT GUARANTEED ACCURATE BY THE REALTORS® ASSOCIATION OF EDMONTON. COPYRIGHT 2025 BY THE REALTORS® ASSOCIATION OF EDMONTON. ALL RIGHTS RESERVED.Trademarks are owned or controlled by the Canadian Real Estate Association (CREA) and identify real estate professionals who are members of CREA (REALTOR®, REALTORS®) and/or the quality of services they provide (MLS®, Multiple Listing Service®)  
Listing information last updated on April 19th, 2025 at 6:17am MDT